

# resi.P INOX LED

IP65

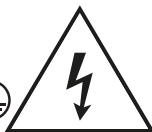

	A	C	D
PERUN LED			
1.2ft	705	135	485
1.4ft	1305	135	1095
1.5ft	1605	135	1395
2.2ft	705	200	485
2.4ft	1305	200	1095
2.5ft	1605	200	1395

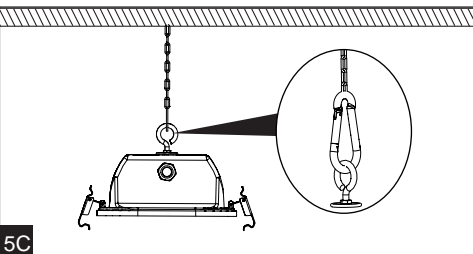
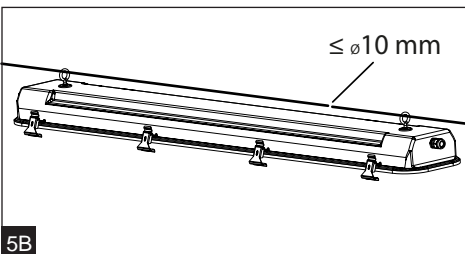
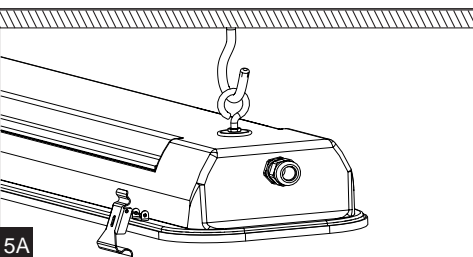
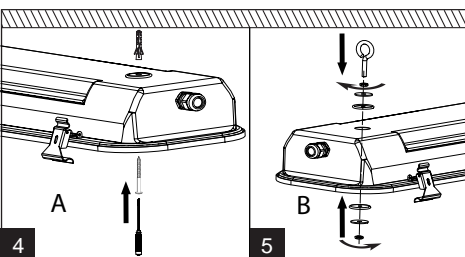
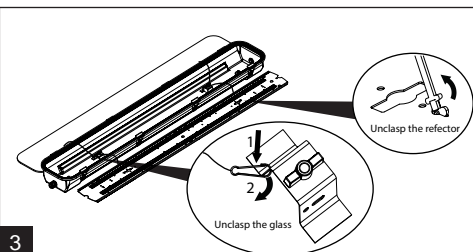
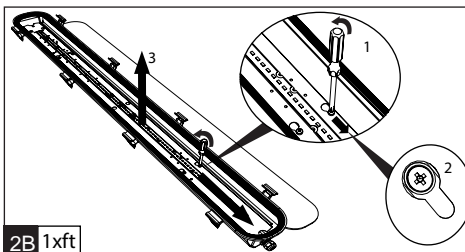
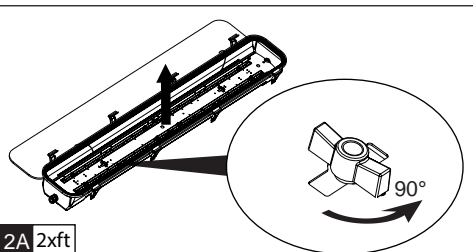
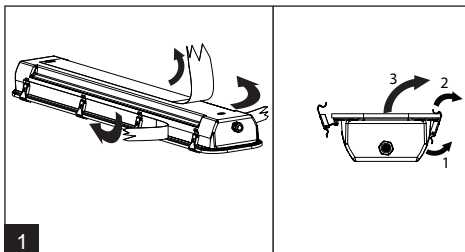
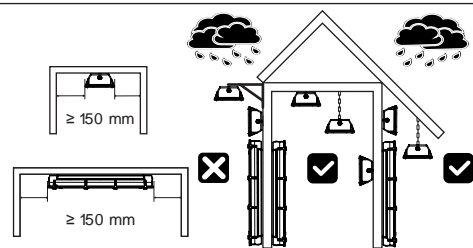

# resi.P INOX LED

IP65



230V  
50/60Hz

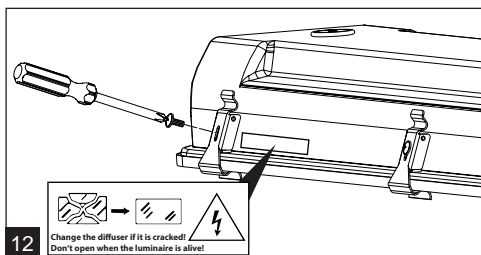
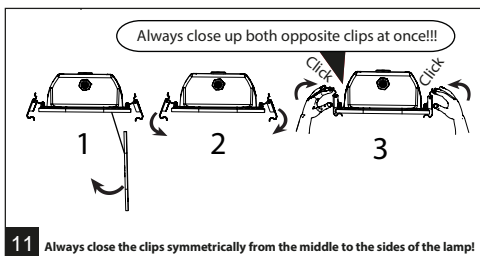
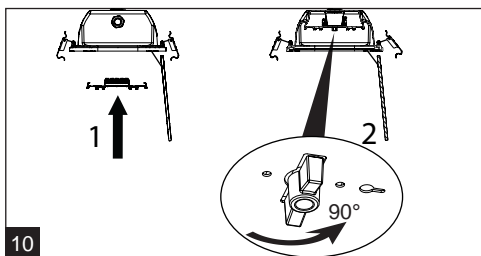
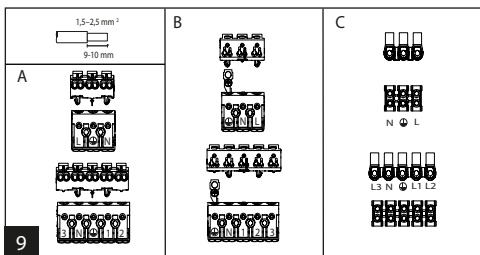
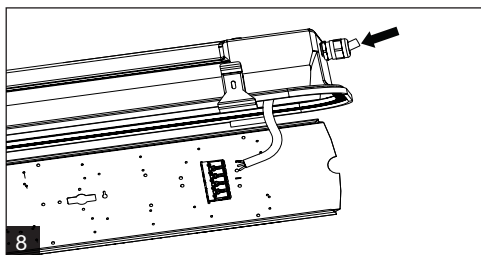
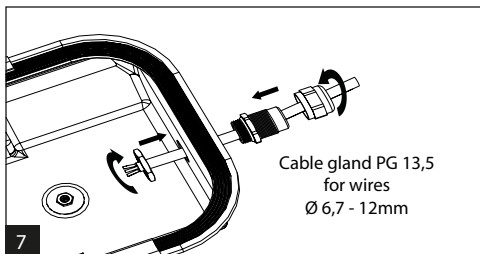
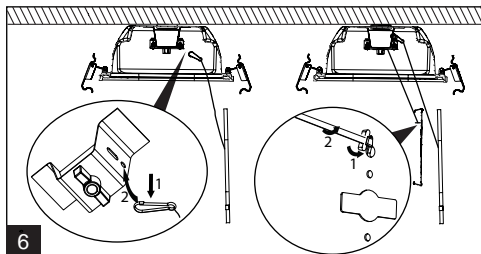
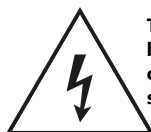

Table of maximal number of luminaires in one line				10A B	16A B	10A C	16A C
Length	Σ1m	Σ2m	Σ3m	luminaires	luminaires	luminaires	luminaires
1.2ft	1300	1600	2200	32	50	52	85
1.4ft	2600			32	50	52	85
1.4ft	3200	4400		10	16	16	26
1.5ft	3250	4000	5500	10	16	16	26
2.2ft	2600			32	50	52	85
2.2ft	3200	4400		10	16	16	26
2.4ft	5200	6400	8800	10	16	16	26
2.5ft	6500	8000	11000	10	16	16	26

Installation can only be carried out by an authorized person and according to the mounting instructions. Any other installation is considered to be improper. For well installation and good luminaire work is necessary ensure a planarity of a mounting surface. Make sure that the luminaire is always disconnected from the power supply before the installation work. Do not use the luminaire if damaged or if damaged the power cable. Only damp microfiber cloth can be used for cleaning. Technical changes are subjected without notice. Do not dispose the luminaire or its parts as household waste, but make the proper recycling.



The light source in this luminaire may be replaced only by the manufacturer or its contractual service technician or similarly qualified person!

Take care while fitting glass on rubber sealing for impacts on side of the glass and fast temperature changes. Properties of heat toughened glass and its susceptibility to breaking follow standard EN 12150-1. For areas where spontaneous fracture of glass means a higher safety risk and/or financial loss, we recommend usage of safety film (SF). Individual cases should be discussed with our technicians.