

# erebia Line LED

IP54

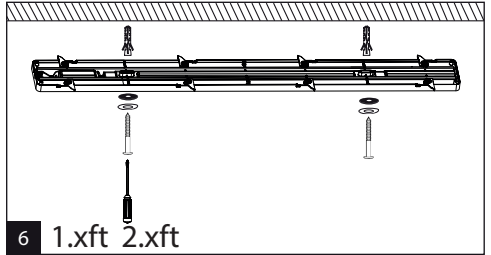

230V  
50/60Hz

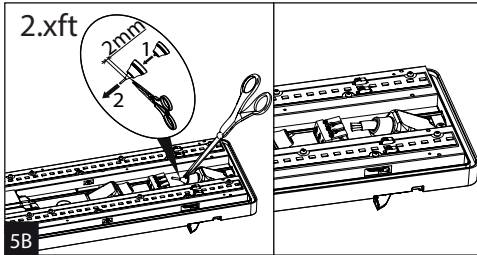
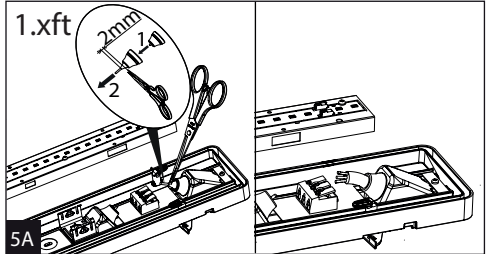
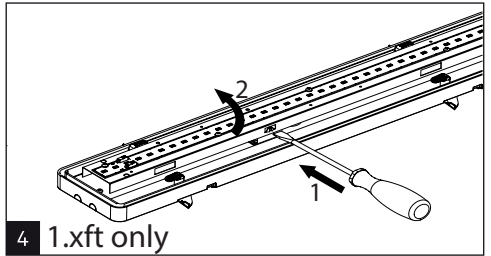
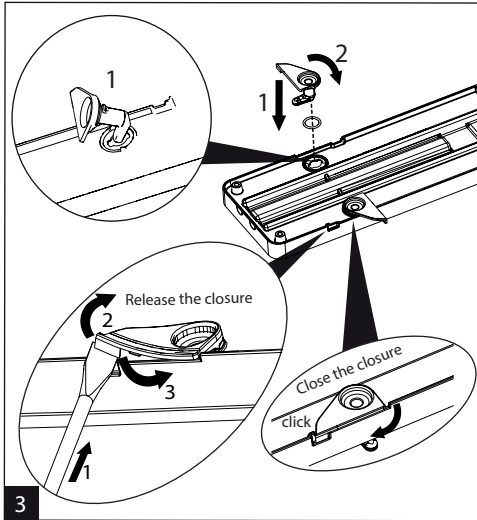
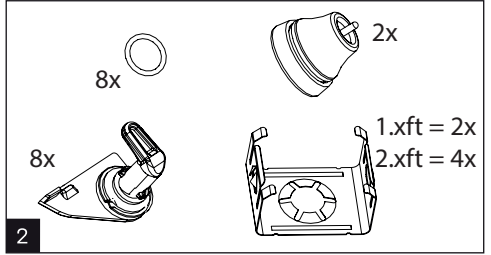
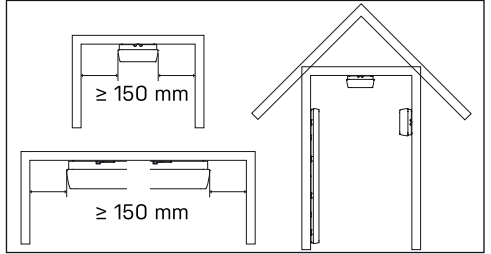
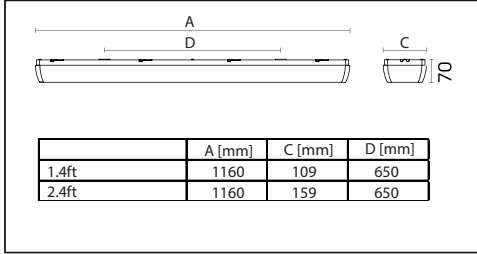
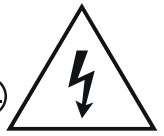

# erebia Line LED

IP54

230V  
50/60Hz

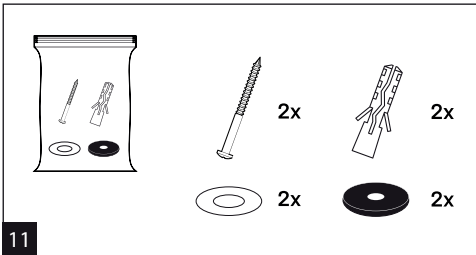
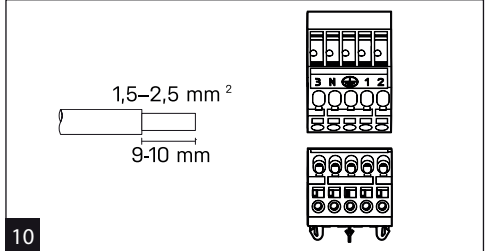
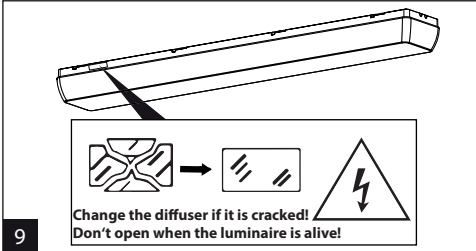
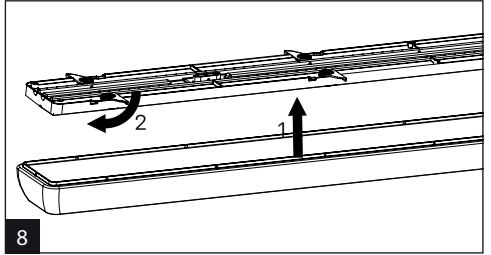
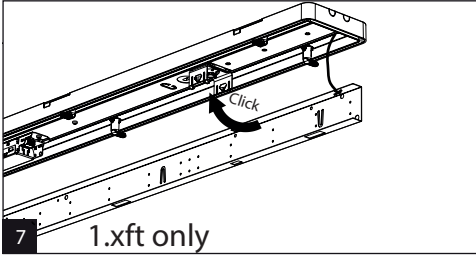
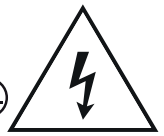
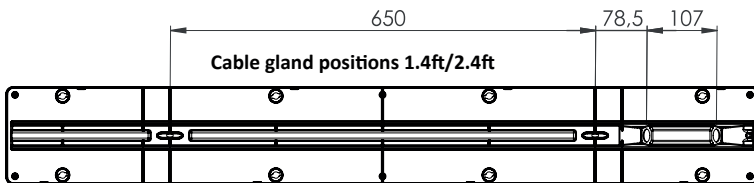

Table of maximal number of luminaires in one line				10A B	16A B	10A C	16A C
Length	Σlm	Σlm	Σlm	Σ luminaires	Σ luminaires	Σ luminaires	Σ luminaires
1.4ft	2600			32	50	52	85
1.4ft	3200	4400		32	50	52	85
2.4ft	5200	6400	8800	10	16	16	26



The light source in this luminaire may be replaced only by the manufacturer or its contractual service technician or similarly qualified person!



Installation can only be carried out by an authorized person and according to the mounting instructions. Any other installation is considered to be improper. For well installation and good luminaire work is necessary ensure a planarity of a mounting surface. Make sure that the luminaire is always disconnected from the power supply before the installation work. Do not use the luminaire if damaged or if damaged the power cable. Only damp microfiber cloth can be used for cleaning. Technical changes are subjected without notice. Do not dispose the luminaire or its parts as household waste, but make the proper recycling.