

# resi.P LED

IP66

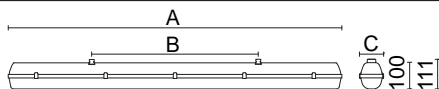

230V  
50Hz



	A [mm]	C [mm]	B [mm]
1.2ft	662	95	350
1.4ft	1272	95	700
1.5ft	1572	95	940
2.2ft	662	145	350
2.4ft	1272	145	700
2.5ft	1572	145	940

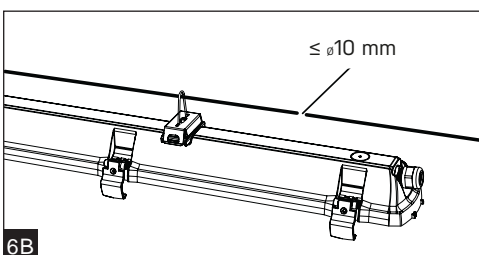
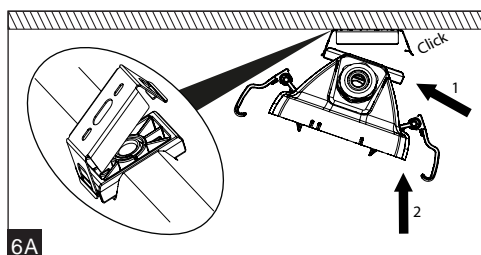
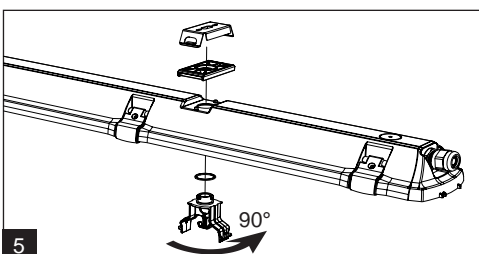
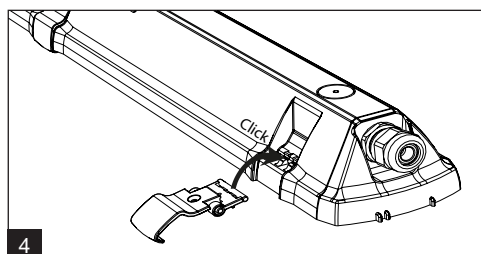
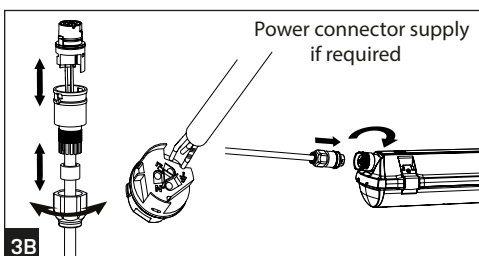
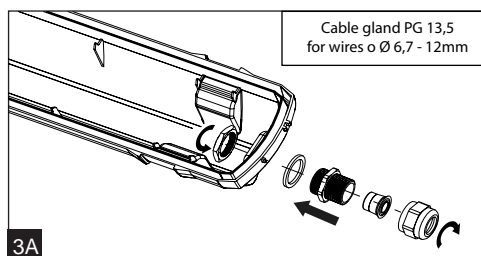
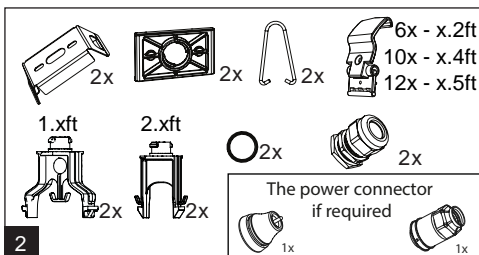
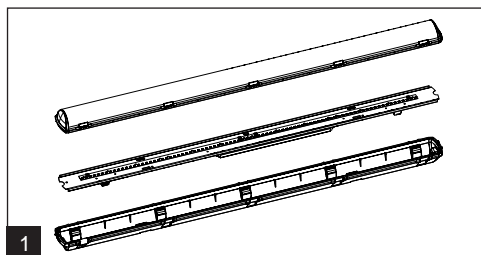
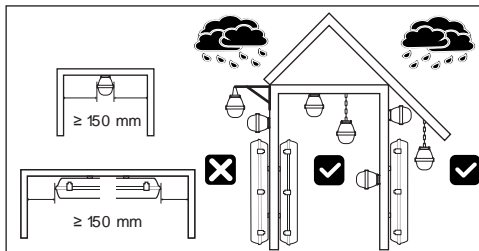

# resi.P LED

IP66

230V  
50Hz

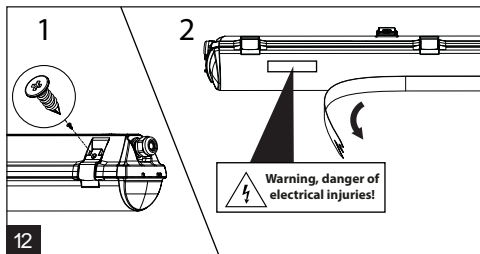
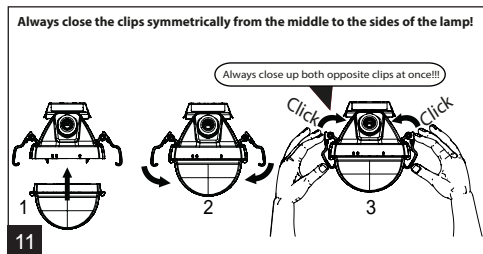
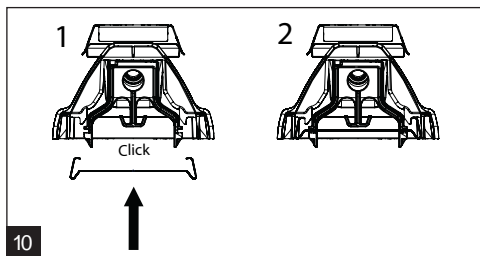
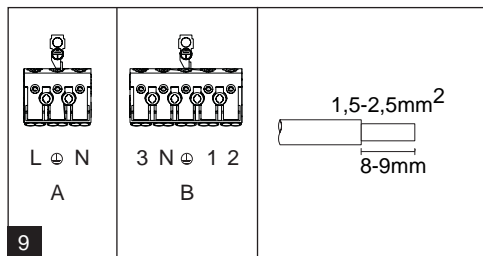
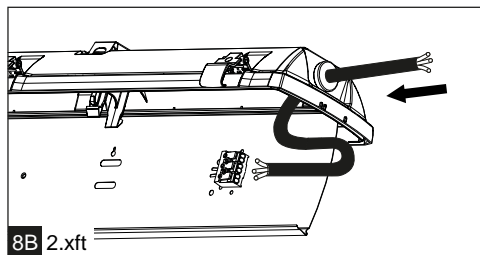
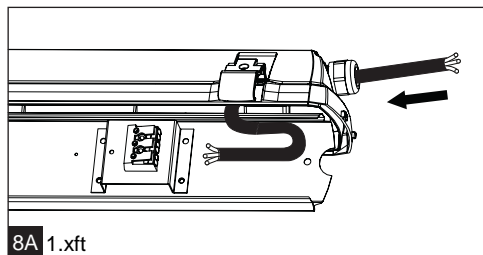
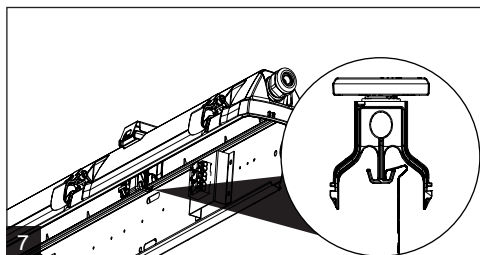
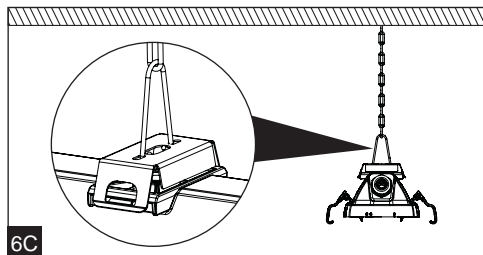

**The light source in this luminaire may be replaced only by the manufacturer or its contractual service technician or a similarly qualified person!**

Installation can only be carried out by an authorized person and according to the mounting instructions. Any other installation is considered to be improper. For well installation and good luminaire work is necessary ensure a planarity of a mounting surface. Make sure that the luminaire is always disconnected from the power supply before the installation work. Do not use the luminaire if damaged or if damaged the power cable. Only damp microfiber cloth can be used for cleaning. Technical changes are subjected without notice. Do not dispose the luminaire or its parts as household waste, but make the proper recycling.

# resi.P LED 2ft

IP66



230V  
50hz

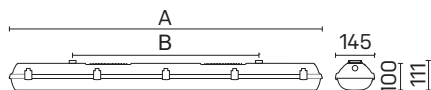

	A [mm]	B [mm]
2.2ft	662	350
2.4ft	1272	700
2.5ft	1572	940

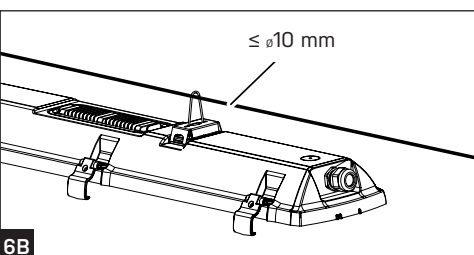
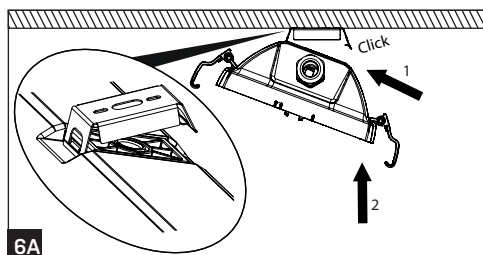
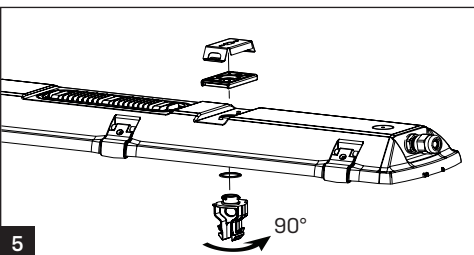
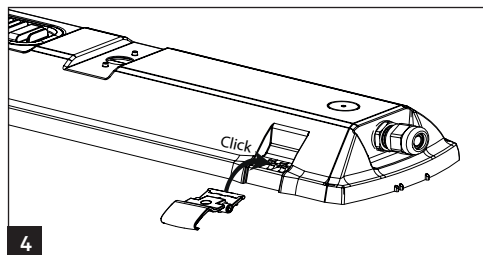
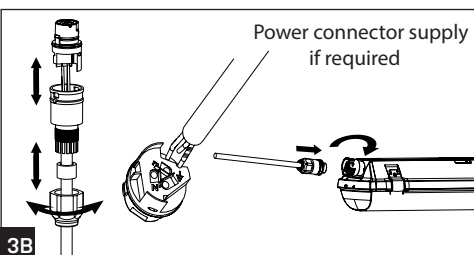
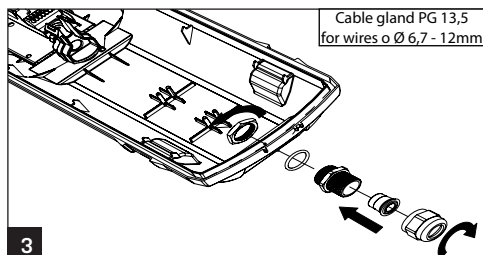
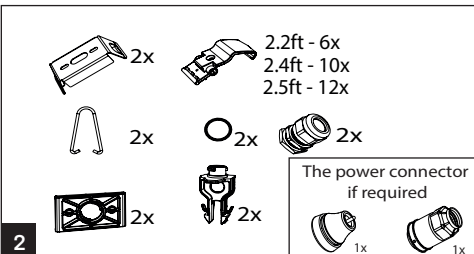
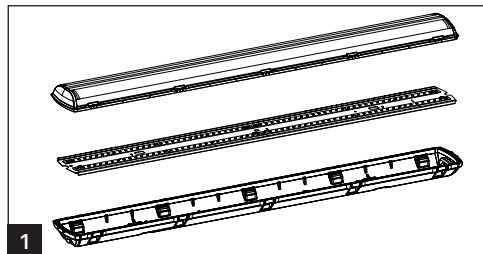
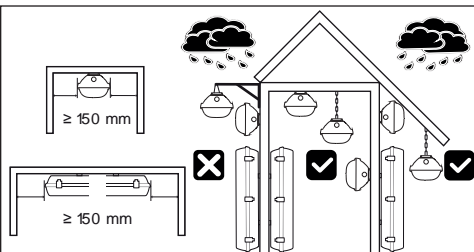

# resi.P LED 2ft

IP66

230V  
50Hz

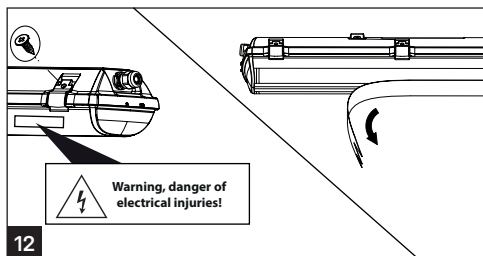
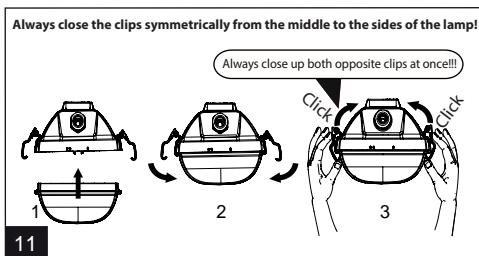
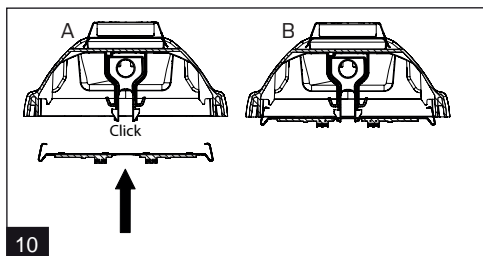
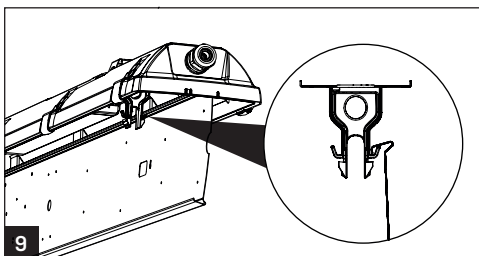
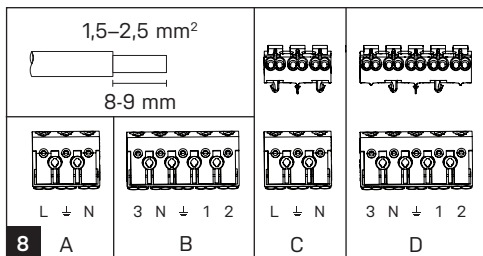
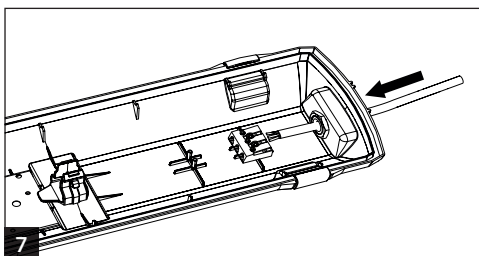
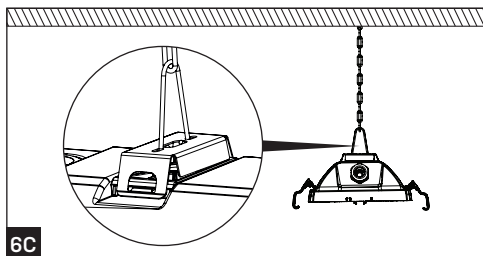

**The light source in this luminaire may be replaced only by the manufacturer or its contractual service technician or a similarly qualified person!**

Installation can only be carried out by an authorized person and according to the mounting instructions. Any other installation is considered to be improper. For well installation and good luminaire work is necessary ensure a planarity of a mounting surface. Make sure that the luminaire is always disconnected from the power supply before the installation work. Do not use the luminaire if damaged or if damaged the power cable. Only damp microfiber cloth can be used for cleaning. Technical changes are subjected without notice. Do not dispose the luminaire or its parts as household waste, but make the proper recycling.